

## Toshiba IK-HD1H

True High-Definition from the World's Smallest Camera Head. Toshiba's HD 3CCD Color Camera System gives you the sharpest, clearest, true color imagery available – from the most compact HD camera on the market.

Our unique prism block technology delivers impeccably sharp detail from a 1.6" camera head. Let Toshiba bring your project to HD life.

The Toshiba IK-HD1H is an ultra-lightweight camera designed for broadcast, medical, scientific and commercial uses. Wherever a super-compact professional-grade camera is necessary, the IK-HD1H has it covered.

Boasting HDTV capabilities, pictures truly come to life, ensuring users see every detail. Features such as a highly sensitive sensor, HD-SDI out, and as sophisticated DSP, make the IK-HD1H a capable performer in almost any specialised video application.



<b>Signal System</b>	1080i
<b>Image Sensor</b>	3x 1/3" IT CCD
<b>Resolution</b>	Horizontal: 800 TV Lines across 56% of screen width (equal 16:9 screen height) Vertical: 800 TV Lines
<b>Number of Pixels</b>	Not Specified By Manufacturer
<b>Lens</b>	Options Available
<b>Iris Operation</b>	Options Available
<b>Minimum Illumination</b>	2000 lux at f/6.8 (100% Video Out) 210 lux at f/2.2 / 0dB (100% Video Out) 105 lux at f/2.2 / 6 dB Gain (100% Video) 13 lux at f/2.2 / 18dB Gain
<b>Signal-to-Noise Ratio</b>	56 dB (Gain @ 0dB + DNR OFF)
<b>Controls</b>	Polecam Compatible
<b>Sync</b>	Internal/External Automatic Switching
<b>Video Output</b>	Composite: BNC Component: BNC HD-SDI: BNC (x1)
<b>Audio Output</b>	No
<b>Motion Detection</b>	No
<b>Alarm I/O</b>	No
<b>Control Ports</b>	RS-232C: 9-Pin Female D
<b>Power Requirements</b>	12 VDC
<b>Power Consumption</b>	10.3W
<b>Operating Temperature</b>	0-40°C(32-104°F)
<b>Dimensions</b>	3.3 x 3.9 x 4cm (1.3 x 1.5 x 4")
<b>Weight</b>	65g (2.3 oz)

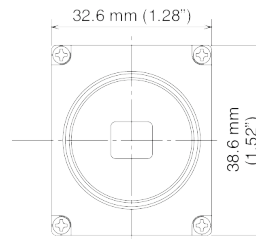

Front

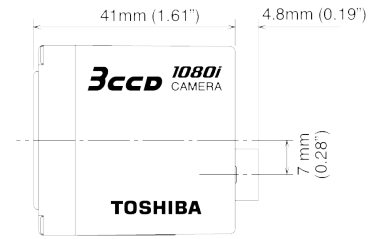

Side

### Applications

- Broadcast
- Homeland Security
- Industrial video / inspection
- Medical
- Scientific imaging / diagnostics

### Features

- 1080i output
- 1920 x 1080 output pixels
- 3CCD (1/3") interlace
- C-mount
- Digital HD-SDI (SMPTE 292M); Analog RGB or Y/ Pb/ Pr
- RS 232C serial interface
- Auto & manual white balance
- Optional accessories: 3, 6, 10 & 30 meter cables; 4mm or 15 mm lens

## IK-HD1 3CCD HD CAMERA

### CAMERA HEAD:

#### SPECIFICATIONS

Image Sensor	3CCD – 1/3 inch interlace
Output Resolution	1920 (H) x 1080 (V)
Sensitivity	F6.8 standard (2000 lux)
Minimum Illumination	13 lux (F2.2, Sensitivity + 18 dB)
S/N Ratio	≥ 54 dB
Lens Mount	C-mount
Ambient Temperature	0°C to 40°C (32°F to 104°F)
Ambient Humidity	Less than 90%
Dimensions	32.6 mm (W) x 38.6 mm (H) x 41 mm (D)
Weight	65 grams (2.3 oz)

Design and specifications are subject to change without notice.

### CONTROLLER:

#### SPECIFICATIONS

Power Requirements	12V DC ± 10%
Power Consumption	10.3W
Output Signal	Digital HD-SDI (SMPTE 292M); Analog RGB or Y/P <sub>b</sub> /P <sub>r</sub>
Frame Rate	30 frames per second
Scene File (user memories)	5 files (A, B, C, D, E)
White Balance	ATW (automatic tracing balance), AWB (automatic white balance), MANUAL
Gain	AUTO (automatic gain control), MANUAL, OFF (0 dB)
Ambient Temperature	0°C to 40°C (32°F to 104°F)
Ambient Humidity	Less than 90%
Dimensions	110 mm (W) x 40 mm (H) x 186 mm (D)
Weight	730 grams (1.61 lbs)

### EXTERIOR DIMENSIONS

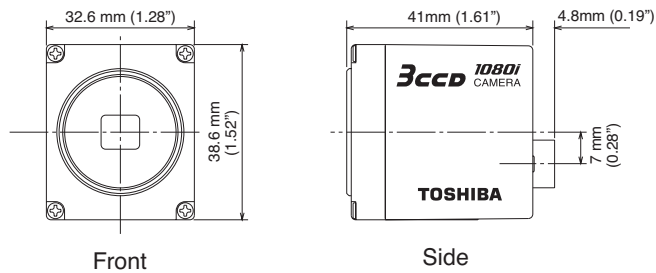

### FRONT AND BACK PANELS

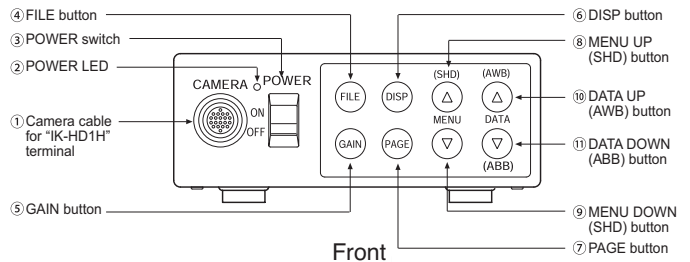

### CONNECTION

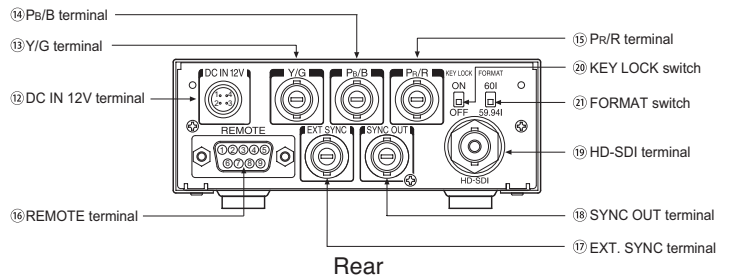
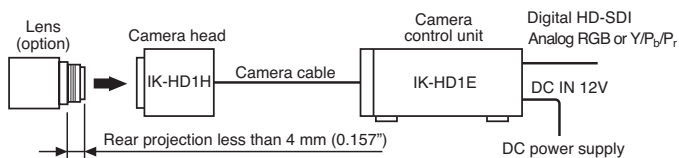

### SYSTEM COMPONENTS

#### Camera System

Model	Description
IK-HD1H	Camera Head
IK-HD1E	Camera Control Unit

#### Camera Cable

Model	Length
EXC-HD03	3 m
EXC-HD06	6 m
EXC-HD10	10 m
EXC-HD30	30 m